

# OIL BRITANNIA



# DISCLAIMER



This presentation is being made on behalf of UK Oil & Gas Investments PLC (the “Company”). This presentation has not been approved for issue as a financial promotion for the purposes of section 21 of the Financial Services and Markets Act (2000) (“FSMA”).

Neither the presentation, nor any part of it, nor anything contained or referred to in it, nor the fact of its distribution, should form the basis of or be relied on in any connection with or act as an inducement in relation to a decision to purchase or subscribe for or enter into any contract or make any other commitment whatsoever in relation to any such securities. Details included in this presentation are subject to updating, revision, verification and amendment, and refer to events as having occurred which have not occurred at the date of this presentation, but which are expected to happen in the future. This presentation does not constitute a recommendation regarding the securities of the Company.

No reliance may be placed for any purpose whatsoever on the information contained in this presentation or on its completeness. No representation or warranty, express or implied, is given by the Company or its advisors or their representative directors, officers, employees, agents or advisors as to the accuracy, fairness, sufficiency or completeness of the information, opinions or beliefs contained in this presentation and, save in the case of fraud, no responsibility or liability is accepted by any of them for the loss, cost or damage suffered or incurred as a result of the reliance on such information, opinions or beliefs. In particular, no representation or warranty is given as to the achievement of reasonableness of, and no reliance should be placed on, any projections, targets, estimates or forecasts and nothing in this presentation is or should be relied on as a promise or representation as to the future.

This presentation is confidential. This presentation may not be copied, reproduced, shown, distributed or issued to any other person at any time without the prior written consent of the Company, nor may the information contained herein be discussed with any other person without the prior written consent of the Company.

By receiving and/or attending this presentation, you agree to be bound by the restrictions in this disclaimer.

If you are in any doubt about the contents of this presentation, you should consult a person authorised under FSMA who specialises in advising on the acquisition of shares and other securities.

# UK ENERGY CONSUMPTION 2014

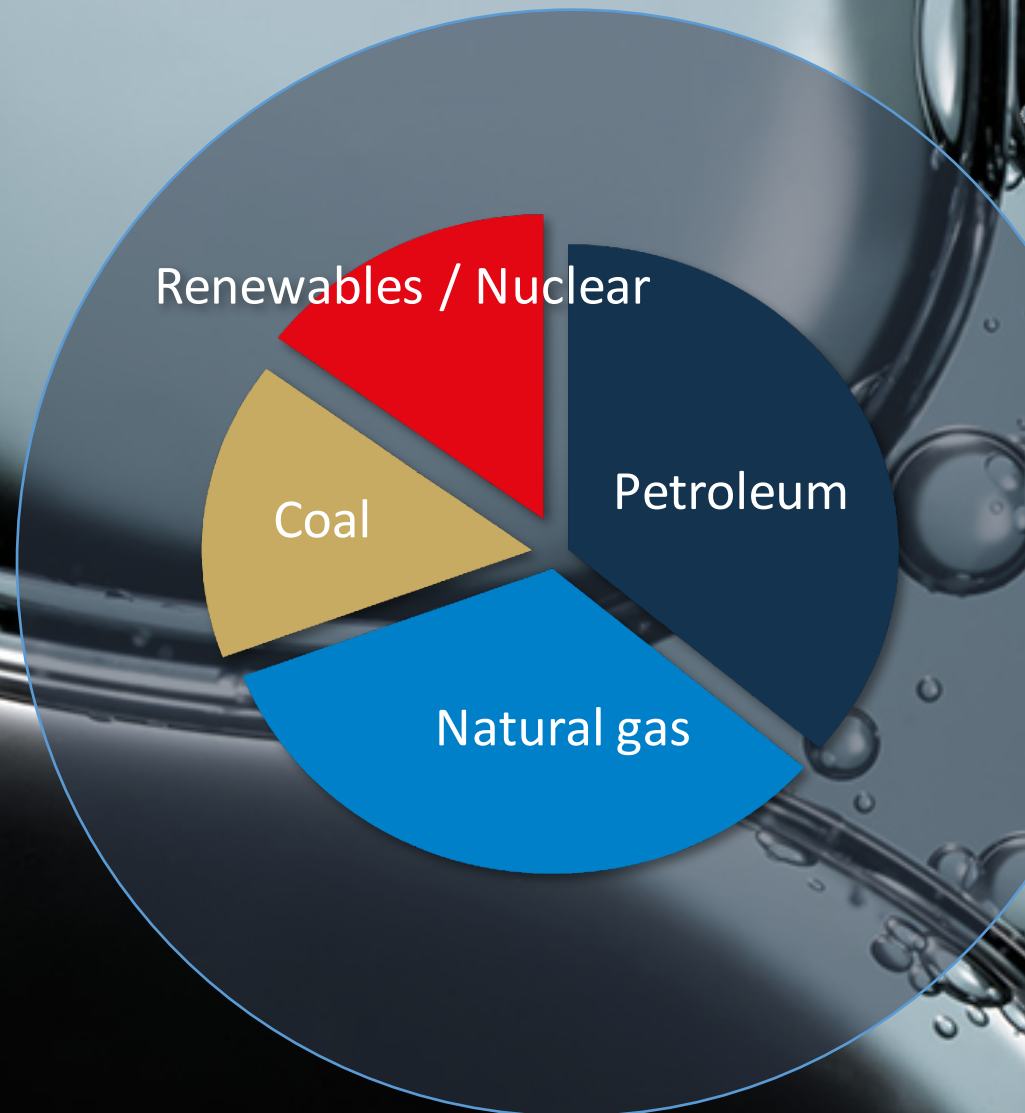

- Oil accounts for 40% of UK energy demand
- Unlike renewables, coal, natural gas, oil is not used primarily to generate electricity
- Used for land, sea, air transport, plastics, pharmaceuticals etc essential for modern life

# RENEWABLES

- Renewables generate electricity. Oil is not used for electric power generation
- Renewable projects need oil based products & components
- Renewables cannot replace oil

# OIL: IMPORTANCE IN DAILY LIFE

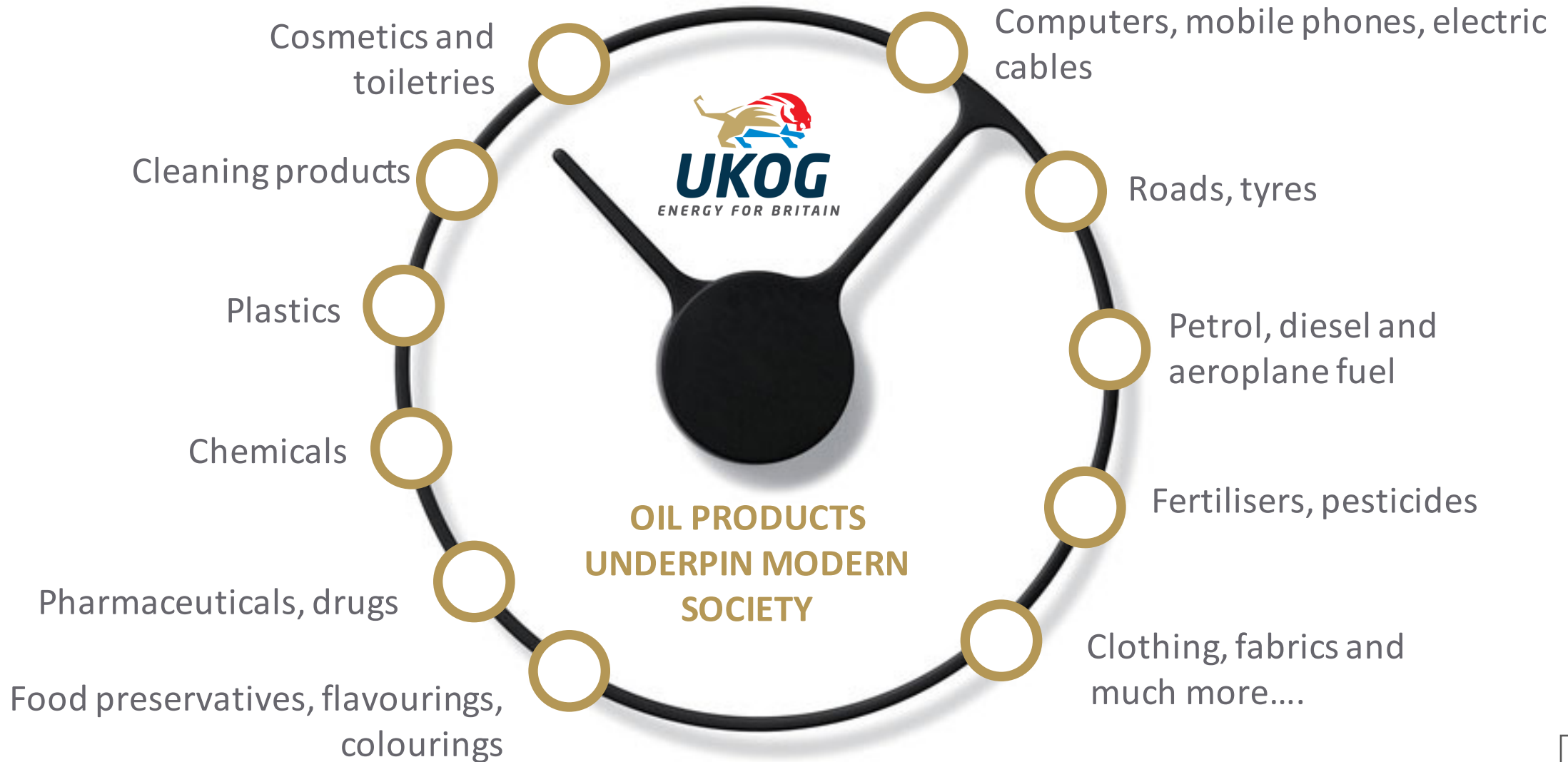

# UK DAILY OIL CONSUMPTION 2014-15

Britain consumes  
**~1.4 million  
barrels per day**

- 70% of it is used as fuel for transport.
- 30% of it is used as petrochemical feedstock
- None of it is used for electricity generation

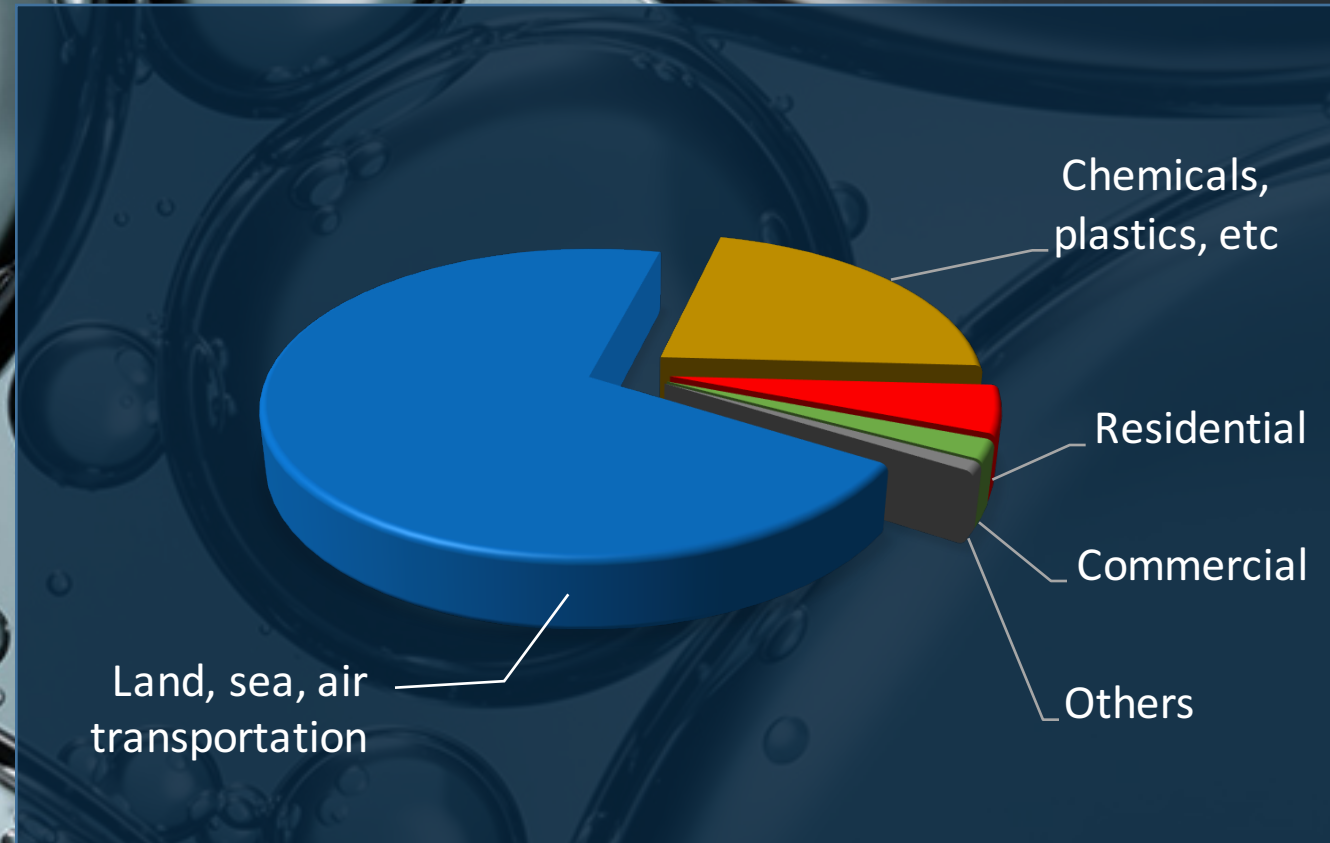

# UK OIL SUPPLY 2016-2030, NORTH SEA DECLINES

**2016** (BOPD)

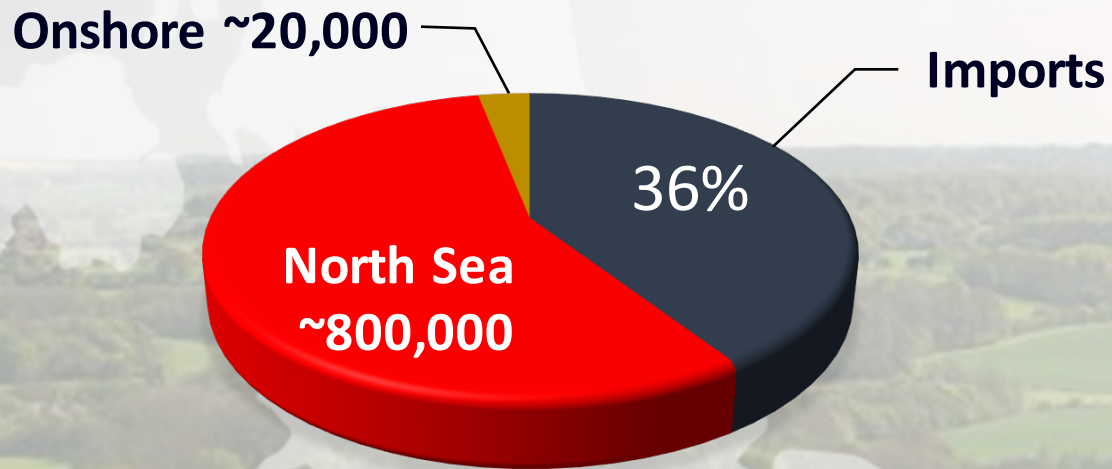

Net oil import dependency  
**36%**

**2030** (BOPD)

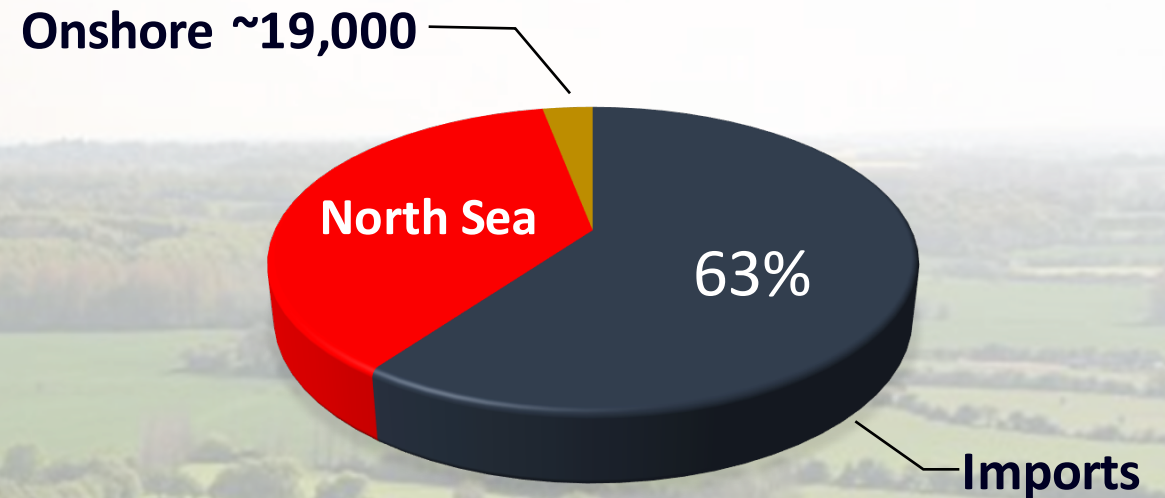

Net oil import dependency  
**63%**

# WEALD KIMMERIDGE OIL CAN INCREASE ENERGY SECURITY

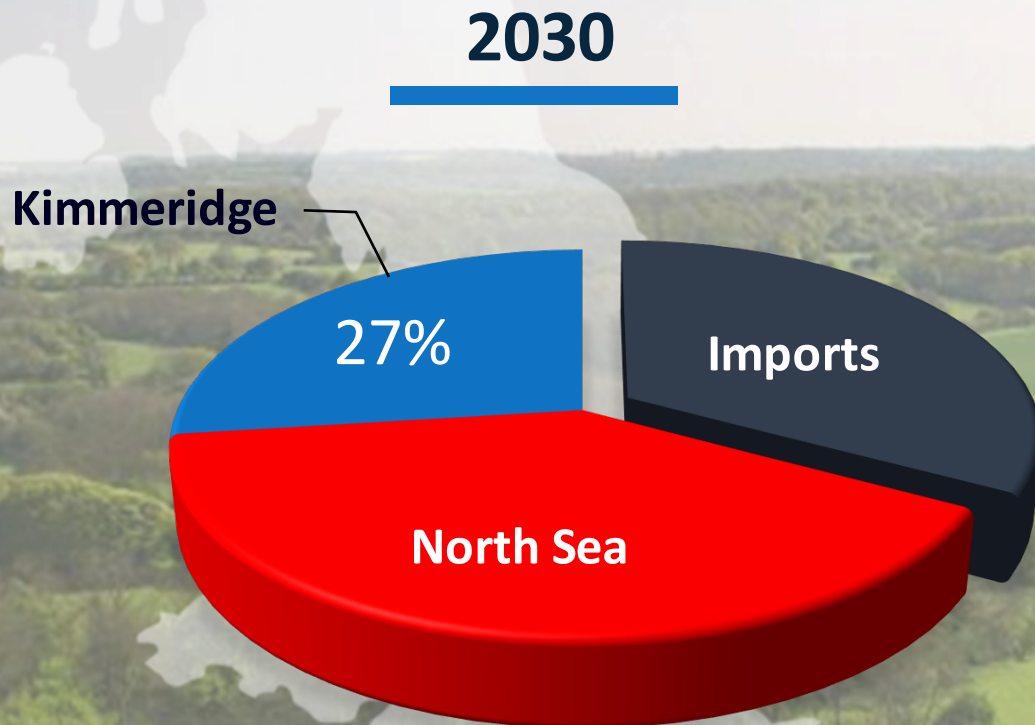

*“Energy security provides the foundation of our future economic success. It is the top priority.”*

Amber Rudd, Secretary of State for Energy and Climate Change

*Kimmeridge Oil can reduce imports by ~27%, create jobs and boost economy*



# GEOLOGY LESSON- KIMMERIDGE BAY

**OIL:** The product of 'cooking' fossil organic matter (OM) in the earth's subsurface. OM derived mostly from fossil plankton and algae.

**SHALE:** A sedimentary rock made of fossilised mud and clay particles, deposited in very fine layers in marine/lake environments.

**SOURCE ROCK:** A rock which generates oil. A shale containing large amounts of organic matter which generates oil.



**Kimmeridge Clay**

# HH-1 OIL DISCOVERY 2014

## Horse Hill 1 - Gatwick Gusher

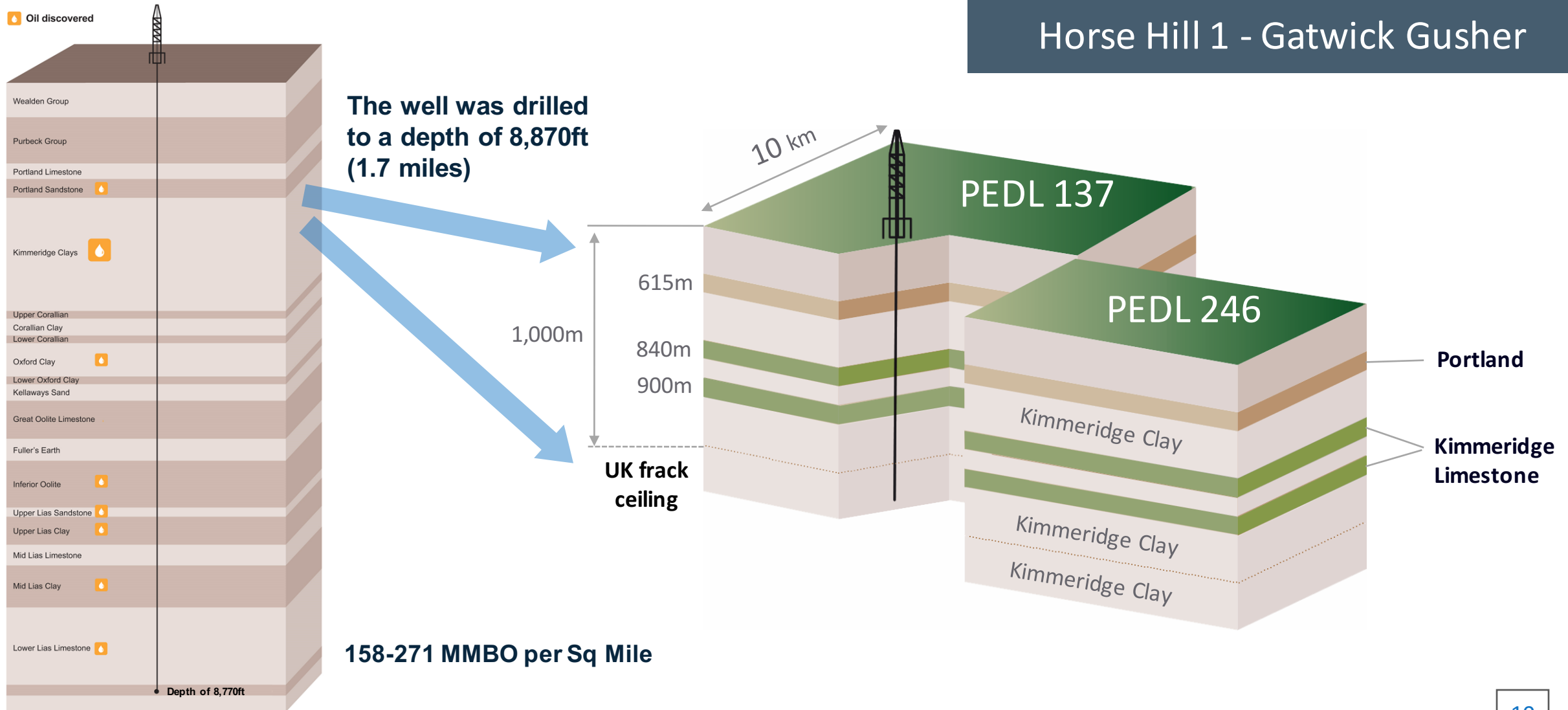

# WEALD BASIN: CALCULATED OIL IN GROUND, post HH-1



**TOTAL WEALD**  
124 billion barrels OIP  
19.5 billion barrels Kimmeridge Limestone

**NUTECH Study area**  
1261 Sq miles

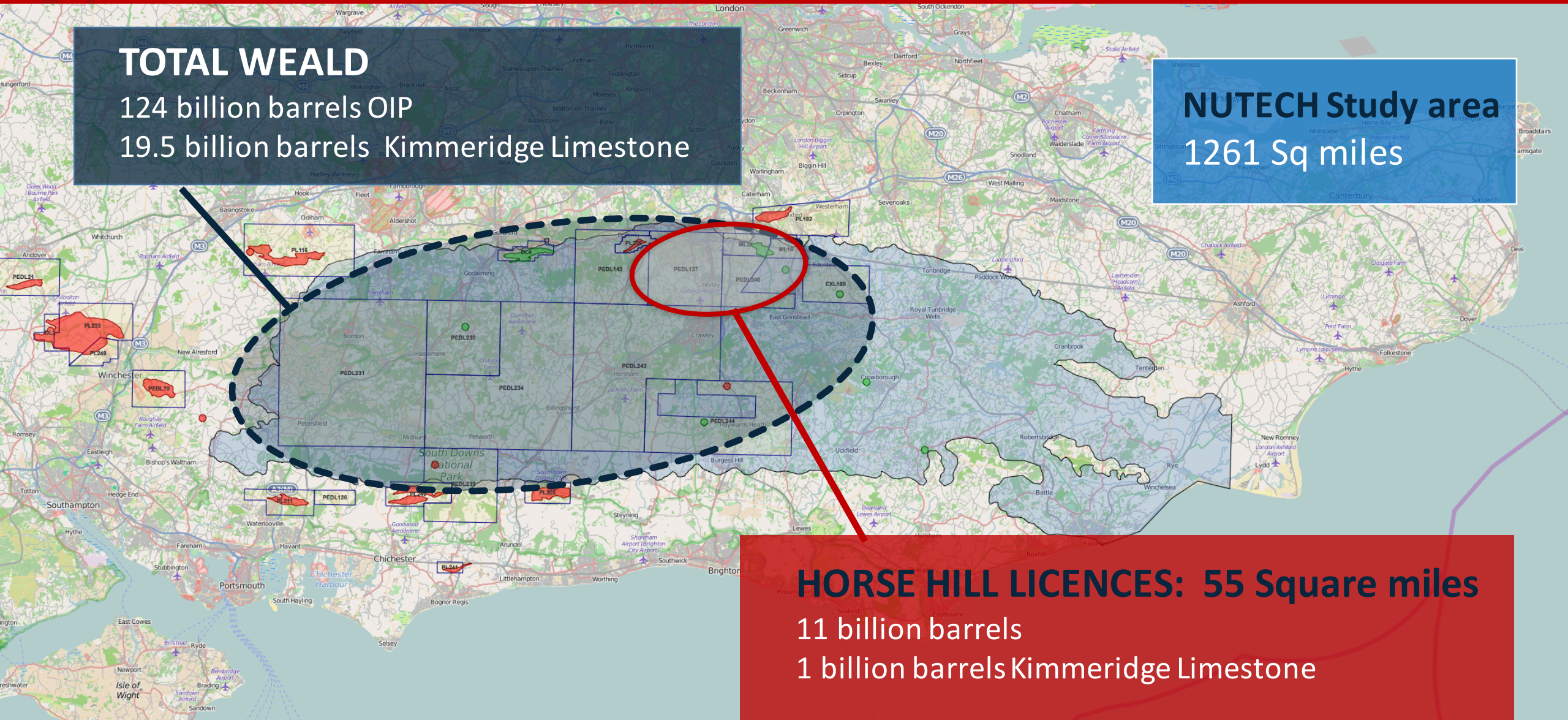

**HORSE HILL LICENCES: 55 Square miles**  
11 billion barrels  
1 billion barrels Kimmeridge Limestone

# GATWICK GUSHER FLOW TEST

First-ever Kimmeridge Limestone Oil

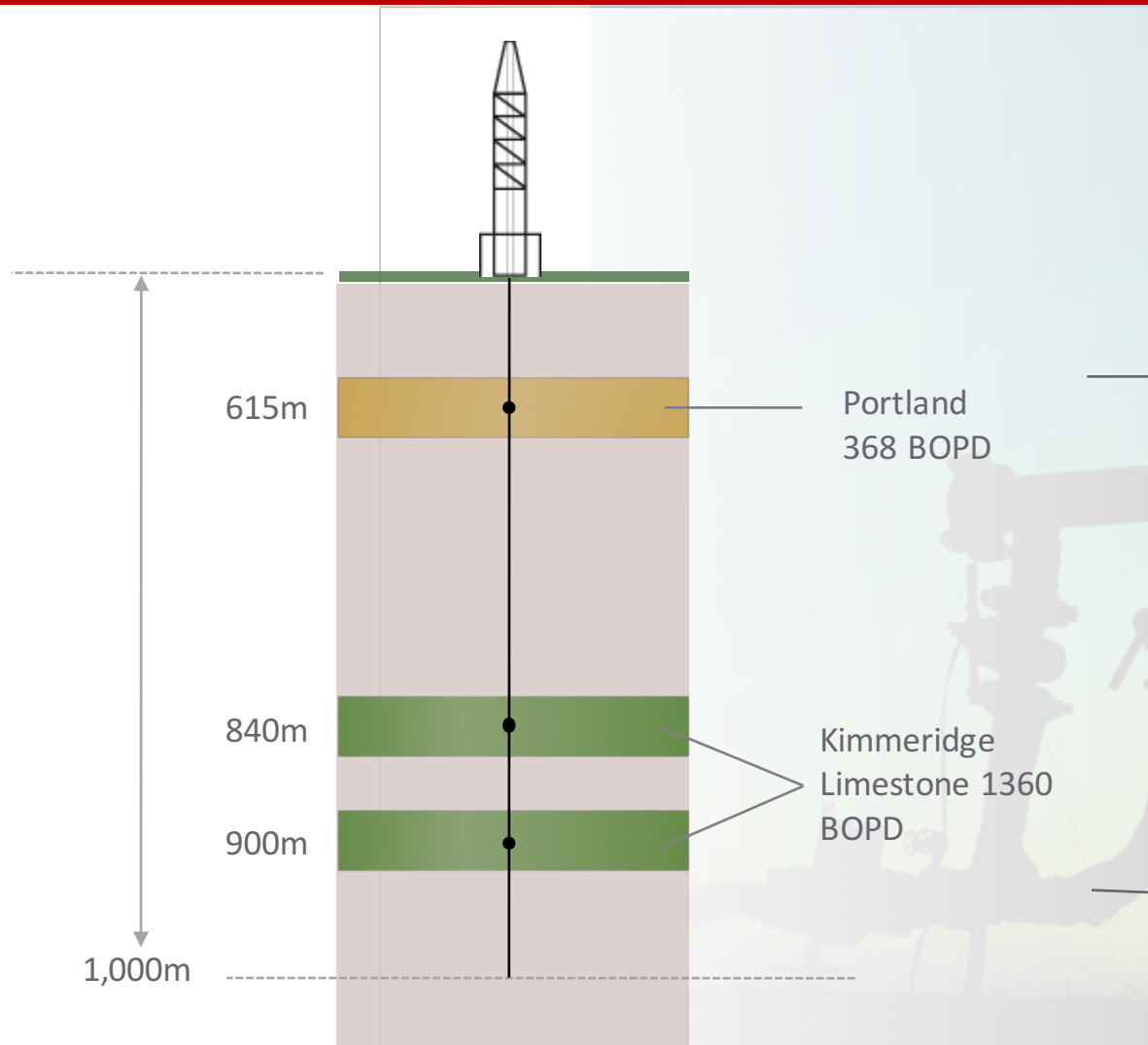

Kimmeridge Limestone Oil:  
From science project to  
commercial reality

- Aggregate oil rate 1,688 BOPD ~ 8.5% of total UK onshore daily oil production
- North Sea rates
- Highest rate of any UK Discovery Well

## Can be produced with low visual impact

- 12-24 wells in 4-6 acre site
- Wells and pumps below ground level
- Control production to reduce initial road tanker impact
- Can be located in brown field sites and away from villages, houses, small roads



# LOW IMPACT DEVELOPMENT PLAN by Xodus Group

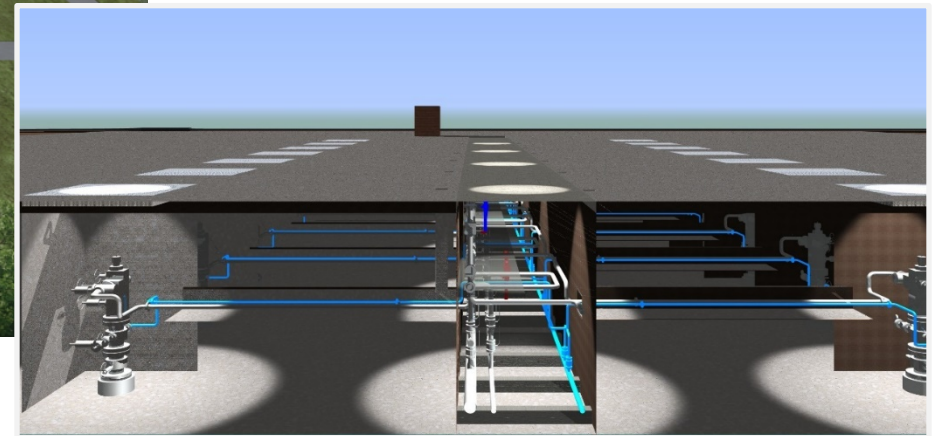
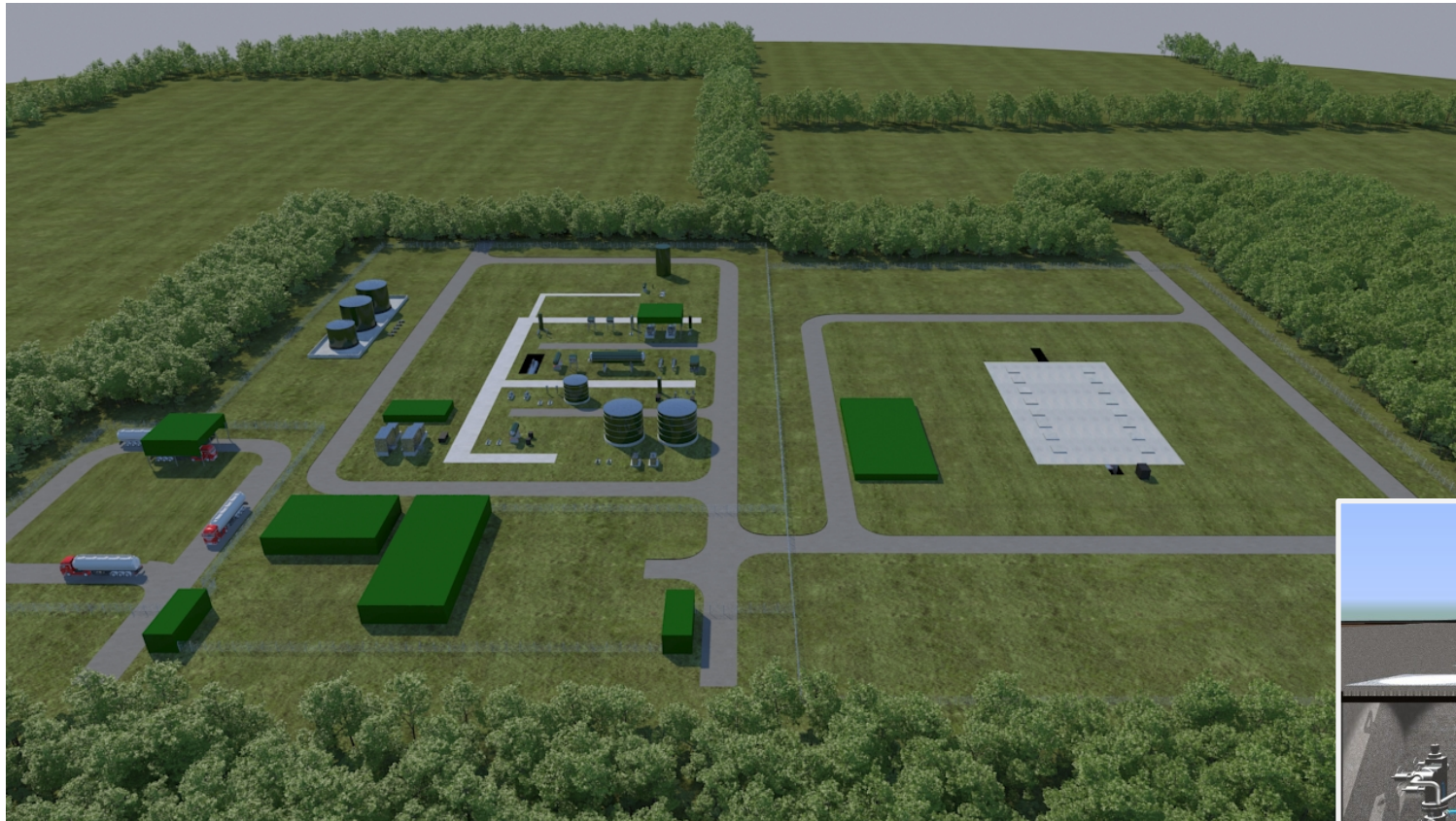

# IMPACT ON UK ECONOMY: EY REPORT



Future peak oil production could provide approximately 4% to 27% of UK daily oil demand over the life of the project

Gross Value Added to the UK economy could range from £7.1 billion to £52.6 billion

Generation of between approximately 1,000 to 5,600 jobs in the UK, averaged over the project's lifetime

Lifetime tax revenues of between £2.1 billion to £18.1 billion

## Development Potential



Horse Hill  
oil licence  
area £

Kimmeridge  
limestones oil in  
entire Weald Basin £

## Supply Chain

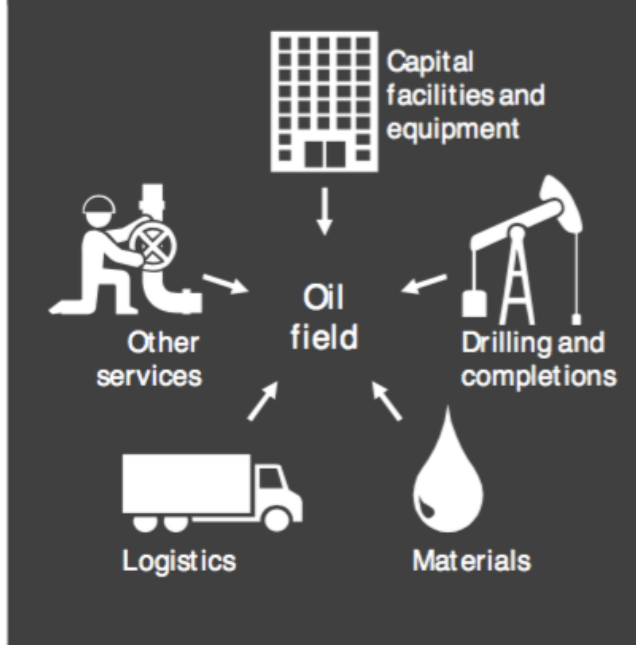

## Fuel

Average oil  
production per  
year...

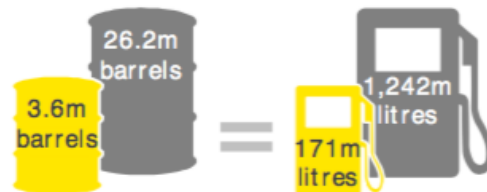

## Economy



## Jobs

Total estimated average  
jobs created ...



## Tax

Estimated lifetime tax  
revenues...



## Community

Total estimated Community  
Benefit...

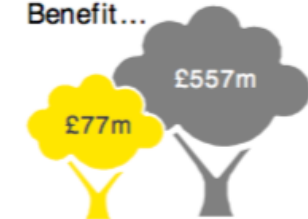

That's enough  
to run



for a whole year\*

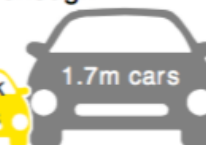

\*based on average fuel consumption  
of new petrol cars in 2014 and  
average annual car mileage in 2012



## The journey has just begun

- Consolidate and increase licences holding in Weald Basin – control the Kimmeridge Oil play
- Bring Horse Hill/Gatwick Gusher to production
  - 3x 90 day production tests (2016)
  - 3D seismic (2017)
  - Horizontal production wells (2017)
- Show HH-1 resources can be repeated to south and west in the Basin sweet-spots
  - Holmwood -1 well (2016/17)
  - 2 others identified wells (2017/18)

Steve Sanderson's presentation  
at Master Investor Show 2016

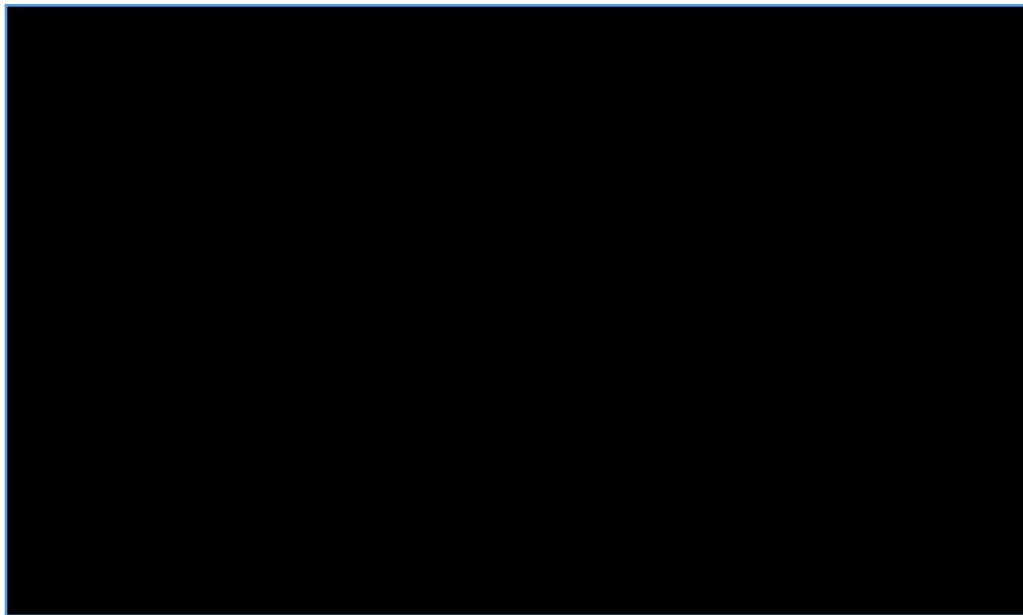

Steve Sanderson's interview  
with TIP TV

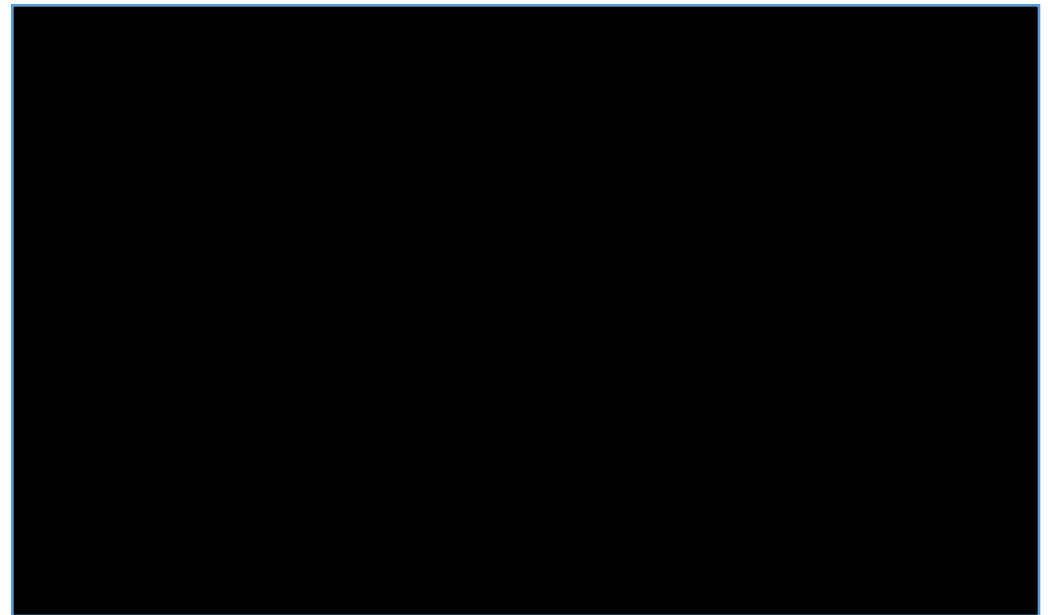

<http://www.ukogplc.com/>

